

For Lease

3028 MERCURY ROAD

Jacksonville, Florida 32207

Warehouse Distribution - Southside Submarket



- **13,000 sq.ft. Warehouse**
- **Great Southside location**
- **(3) Dock High Doors**
- **1500 sq.ft. Office**
- **Water / Sewer included**
- **Zoned IL**
- **15' Ceiling Height**
- **Concrete Masonry Construction**
- **60,000 sq.ft. total building**
- **Remodeled**

Lease Rate: \$6.00 per sq.ft. NNN

\$.98 /sq.ft. CAM

\$7,562. mo. gross plus FL sales tax

AVAILABLE: 12-1-2021

Contact:

Wayne Sanderson

(904) 356-2228

wsanderson@esresults.com

Easton, Sanderson & Company

Industrial - Commercial R.E. Sales, Leasing & Management

300 E. State Street (Suite G) Jacksonville, FL. 32202

www.esresults.com Licensed Real Estate Brokers



For Lease

3028 MERCURY ROAD
Jacksonville, Florida 32207
Warehouse Distrib. - Southside Submarket

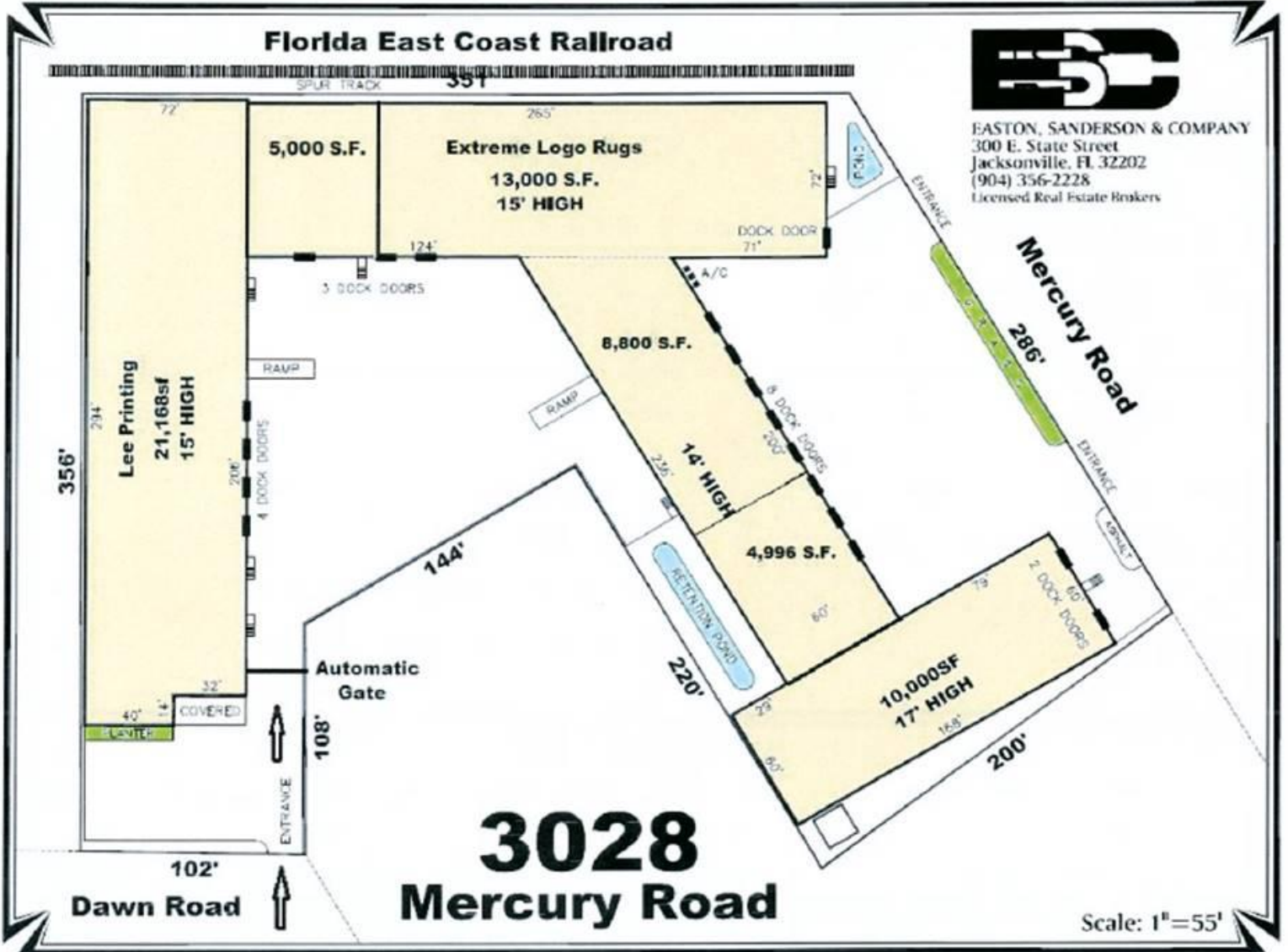

For More Information:
Wayne Sanderson
(904) 356-2228
wsanderson@esresults.com

Easton, Sanderson & Company

Industrial - Commercial R.E. Sales, Leasing & Management
300 E. State Street (Suite G) Jacksonville, FL. 32202

www.esresults.com Licensed Real Estate Brokers



For Lease

3028 MERCURY ROAD
Jacksonville, Florida 32207
Warehouse Distrib. - Southside Submarket



For More Information:
Wayne Sanderson
(904) 356-2228
wsanderson@escrelts.com

Easton, Sanderson & Company

Industrial - Commercial R.E. Sales, Leasing & Management
300 E. State Street (Suite G) Jacksonville, FL. 32202
www.escrelts.com Licensed Real Estate Brokers

